

# CONTROL SURVEY MONUMENT DATA AND RECOVERY SHEET

## City of Oceanside Geodetic Control Network



Number: **1019** **SET**  
 Name: **FOUSSAT RD. & MISSION AVE.**



<b>Monument Description:</b> 2.5" Brass Disk set in Curb Inlet	<b>GPS Useable:</b> Yes	<b>Additional Stamping:</b> City of Oceanside Survey Control Station 1019 2013
<b>Stamping:</b> LS 7854		
<b>Center Mark:</b> Triangle / Punch		<b>Depth:</b> 0
<b>Recovery By:</b> RBF	<b>Date:</b> May 2013	<b>Lid:</b>



**Location:**  
 On top of westerly curb inlet of Foussat Road (+/-) 180' northerly of Mission Avenue

California Geodetic Coordinates of 1983			CCS 83, Zone 6 Coordinates		NAD83(NSRS2007)		
	Deg. Min. Seconds		Meters	U.S. Survey Feet	Epoch:	2011.00	
Latitude:	33 13 2.10069	Northing:	617,047.075	2,024,428.61	FGDC Acc.:	1 cm	
Longitude:	117 20 37.89695	Easting:	1,898,032.842	6,227,129.42	Survey by:	RBF	
Ellipsoid Height (m):	-24.095	Combined Factor:	0.99995999		Adj. Date:	Oct 2013	
California Orthometric Height (COH88)							
Datum	Meters	U.S. Survey Feet	Survey By	FGDC Acc.	Adj. Date	COH88	Geoid12A
NAVD88	10.324	33.87	RBF	2 cm	Oct 2013	Derived	-34.426

050458

# CORNER RECORD

Agency Index \_\_\_\_\_  
Document Number 160-271-60

City of OCEANSIDE County of SAN DIEGO, California

Brief Legal Description PORTION OF PARCEL 1 OF PARCEL MAP NO. 9315

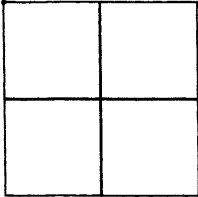

### CORNER TYPE

Government Corner  Control  
Meander  Property  
Rancho  Other

### COORDINATES (Optional)

N. \_\_\_\_\_ E. \_\_\_\_\_  
Elevation \_\_\_\_\_  
Units Metric  U.S. Survey Foot   
Horizontal Datum \_\_\_\_\_  
Zone \_\_\_\_\_ Epoch Date \_\_\_\_\_  
Vertical Datum \_\_\_\_\_

Date of Survey 8/17/22

Complies with Public Resources Code §§8801-8819  
 Complies with Public Resources Code §§8890-8902

PLS Act Ref:  8765(d)  8771  8773  Other:

Corner/Monument:  Left as found  Established  Rebuilt  Pre-Construction  
 Found and tagged  Reestablished  Referenced  Post-Construction

Narrative of corner identified and monument as found, set, reset, replaced, or removed:

See sheet #2 for description (s):

### SURVEYOR'S STATEMENT

This Corner Record was prepared by me or under my direction in conformance with the Professional Land Surveyors' Act on AUGUST 17, 2022

Signed [Signature] P.L.S. No. 9296



### COUNTY SURVEYOR'S STATEMENT

This Corner Record was received 6/16/22  
and examined and filed SEP 09 2022

Signed [Signature] P.L.S. or R.C.E. No. 8384

Title FOR THE COUNTY SURVEYOR



County Surveyor's Comment \_\_\_\_\_

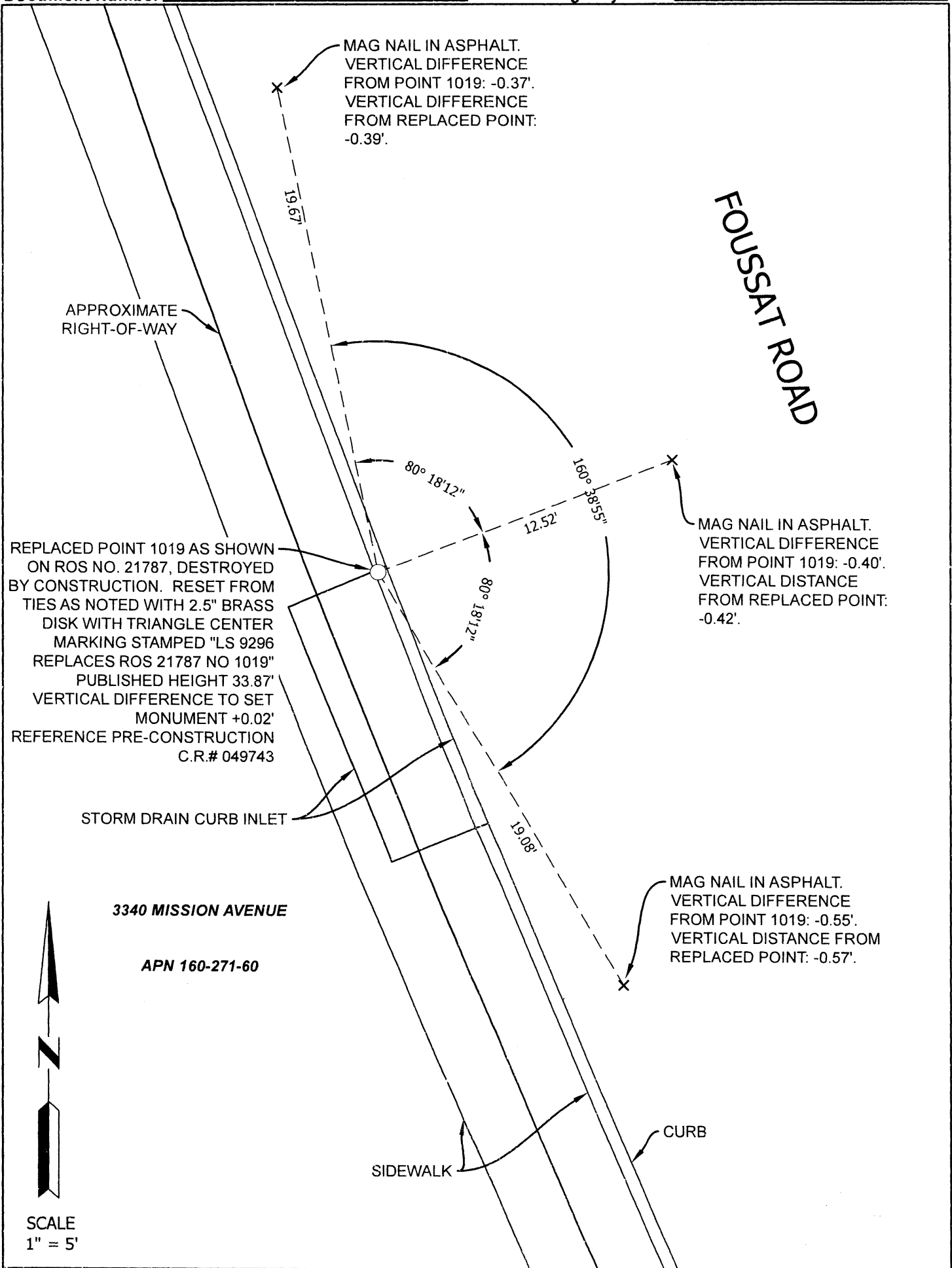

049743

# CORNER RECORD

Agency Index \_\_\_\_\_

Document Number 160-271-60

City of OCEANSIDE

County of SAN DIEGO, California

Brief Legal Description PORTION OF PARCEL 1 OF PARCEL MAP NO. 9315

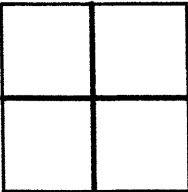

### CORNER TYPE

Government Corner  Control  
Meander  Property  
Rancho  Other

Date of Survey 4/19/22

### COORDINATES (Optional)

N. \_\_\_\_\_ E. \_\_\_\_\_

Elevation \_\_\_\_\_

Units Metric  U.S. Survey Foot

Horizontal Datum \_\_\_\_\_

Zone \_\_\_\_\_ Epoch Date \_\_\_\_\_

Vertical Datum \_\_\_\_\_

Complies with Public Resources Code §§8801-8819

Complies with Public Resources Code §§8890-8902

PLS Act Ref:  8765(d)  8771  8773  Other:

Corner/Monument:  Left as found  Established  Rebuilt  Pre-Construction

Found and tagged  Reestablished  Referenced  Post-Construction

Narrative of corner identified and monument as found, set, reset, replaced, or removed:

See sheet #2 for description (s):

### SURVEYOR'S STATEMENT

This Corner Record was prepared by me or under my direction in conformance with the Professional Land Surveyors' Act on MAY 11, 2022

Signed [Signature] P.L.S. No. 9296



### COUNTY SURVEYOR'S STATEMENT

This Corner Record was received 4/19/2022

and examined and filed MAY 20 2022

Signed [Signature] P.L.S. or R.G.E. No. 7863

Title FOR THE COUNTY SURVEYOR



County Surveyor's Comment \_\_\_\_\_

\_\_\_\_\_  
\_\_\_\_\_

