

CONTROL SURVEY MONUMENT DATA AND RECOVERY SHEET

City of Oceanside Geodetic Control Network

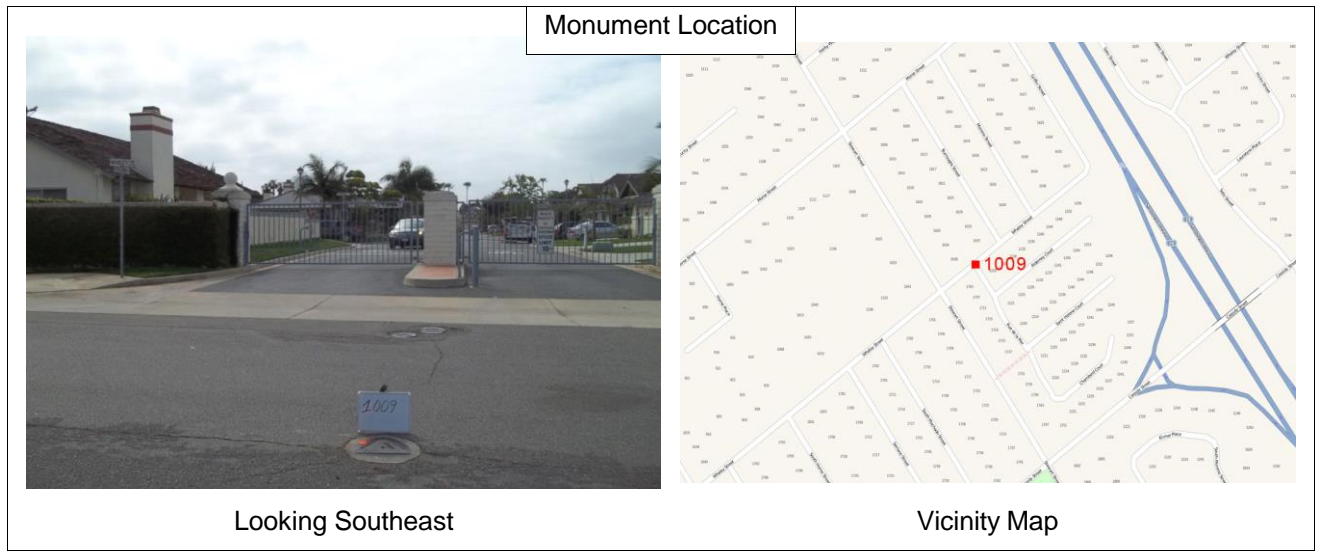

Number: **1009** **FOUND**
 Name: **WHALEY ST. & RUE DE LA MER DR.**



Monument Description: 3.5" Brass Disk in Monument Well		GPS Useable:	Yes
Stamping: RCE 22015			
Center Mark: Punch		Depth:	-0.45
Recovery By: RBF	Date: May 2013	Lid: Monument	



Location:
 Monument Well at apparent intersection of Whaley Street and Rue De La Mer Drive

California Geodetic Coordinates of 1983				CCS 83, Zone 6 Coordinates			NAD83(NSRS2007)	
Latitude:	Deg.	Min.	Seconds	Northing:	Meters	U.S. Survey Feet		
	33	10	50.34502		613,001.521	2,011,155.82		
Longitude:	117 21 25.98185		Easting:	1,896,744.685	6,222,903.19			
	-13.338			Combined Factor:	0.99995980			
Epoch:		2011.00		FGDC Acc.:		1 cm		
Survey by:		RBF		Adj. Date:		Oct 2013		

California Orthometric Height (COH88)							
Datum	Meters	U.S. Survey Feet	Survey By	FGDC Acc.	Adj. Date	COH88	Geoid12A
NAVD88	21.316	69.94	RBF	2 cm	Oct 2013	Derived	-34.661